

(Sw 205 & 206)

204

Not Pat

2038

C79-95 & 96

David Gilliland

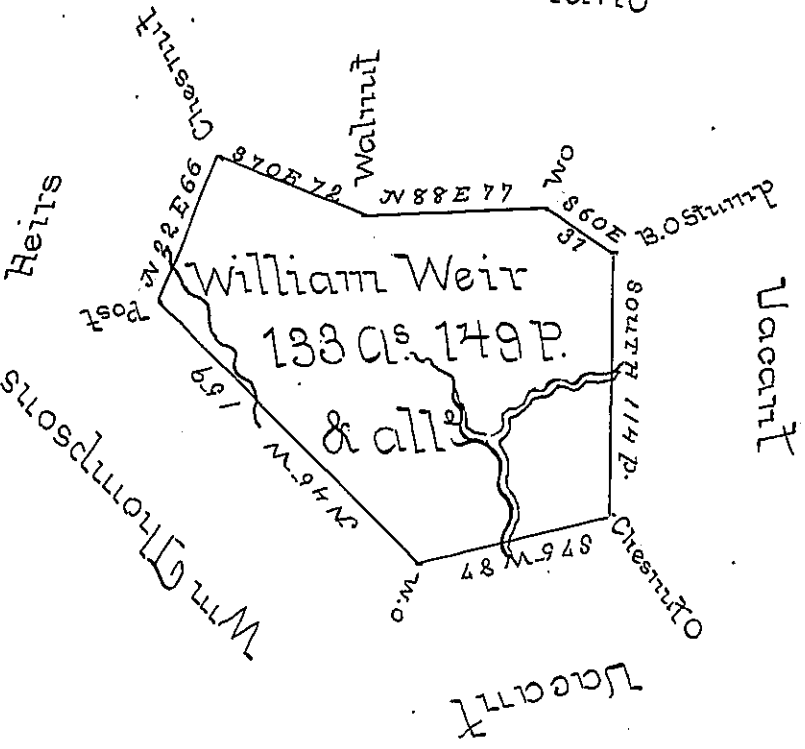

In Pursuance of a Warrant bearing date May the 2<sup>nd</sup> 1785 Surveyed on the 18<sup>th</sup> day of September 1786 unto William Wier in Right of Adam Gilliland the above Discribed Tract of Land Situate in Pitt Township in the County of Westmoreland Containing One Hundred and Thirty Three Acres 149 Perches & Allowance of Six P<sup>er</sup> Cent for Roads &c

Benz Lodge D.S

To John Lukens Esq<sup>r</sup> }  
Surveyor General.

IN TESTIMONY that the above is a copy of the original remaining on file in the Department of Internal Affairs of Pennsylvania, made conformably to an Act of Assembly approved the 16th day of February, 1833, I have hereunto set my Hand and caused the Seal of said Department to be affixed at Harrisburg, this Second day of February 1897.

James W. Jatta  
Secretary of Internal Affairs.